



ELECTRIC V-BOX SPREADER

PVAS G3

OWNER'S MANUAL

Revised 6-December-2010

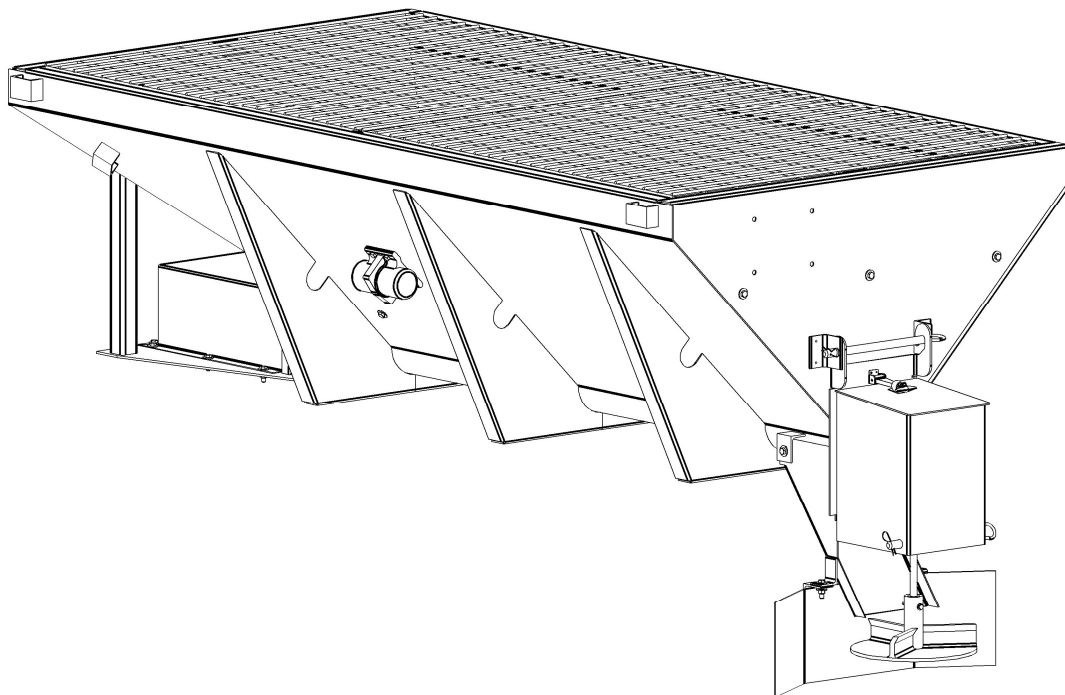



TABLE OF CONTENTS

Package Contents	3
Safety.....	4
Installation Instructions	5
Wiring Harness Installation.....	8
Maintenance	13
Avalanche® Warranty	14
Product Registration	15
Contact Information	16

Need Help? Call 1-800-232-6950



PACKAGE CONTENTS

- 1 V-box spreader
- 1 Wiring Harness
- 1 Electronic control unit
- 1 Top screen
- 1 Inverted v
- 1 Vibrator switch
- 1 Fastener box
- 1 Package of electrical connectors
- 4 Straps



SAFETY

DANGER

When powering on the spreader, the electronic control system will automatically perform a power-on self test (POST). During this test, the spinner and auger will turn for approximately 5 seconds. Please ensure that the spinner is not positioned in front of people or vehicles during this routine test.

DANGER

Stay clear while spinner is turning.

DANGER

Power off the controller before servicing or cleaning the salt spreader.

IMPORTANT

Do not power wash near electrical components. Damage to the electrical components may result.

INSTALLATION INSTRUCTIONS

1. Bolt two 2x4s to the spreader chassis (four bolts used on the spreader). The 2x4s are installed laterally.
2. Bolt the spreader via the 2x4s to the floor of the pickup truck or flatbed. The spreader should be bolted onto a solid section of the truck floor. (Four bolts are used to mount it to the truck floor.)
3. Secure the spreader to the pickup truck body using the straps included with your spreader package. Connect two straps at the front of the spreader, and connect the other two straps at the rear of the spreader to the rear of the pickup truck.
4. Install the spinner chute using the bolts and nuts provided. Install the deflector to the chute tabs, and install the spinner assembly to the same tabs.

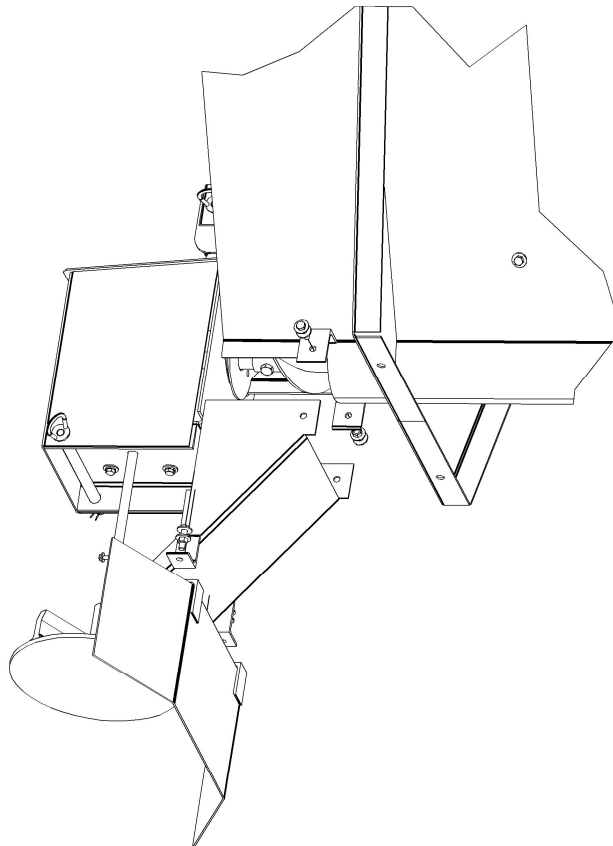

5. Slide the spinner over the motor shaft and install the spinner shaft bolt and nut. Install and tighten the fasteners provided.

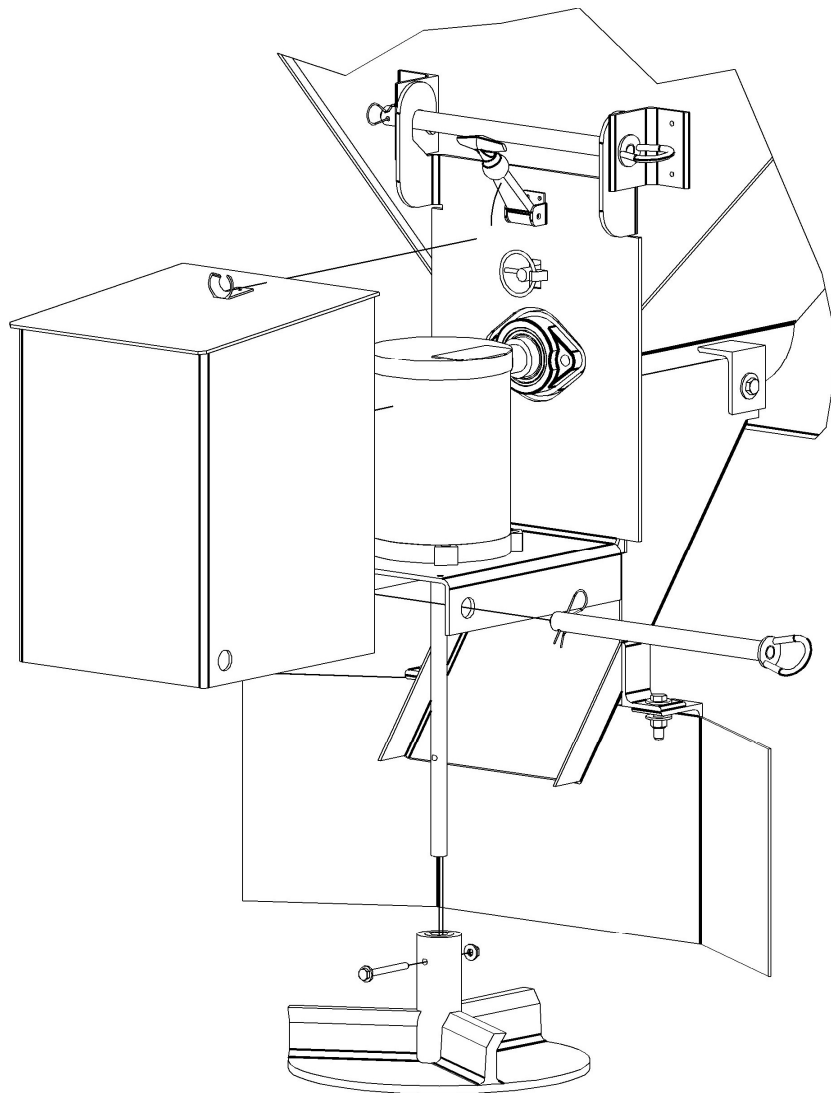

6. Install spinner motor housing using the pin and rubber strap provided.

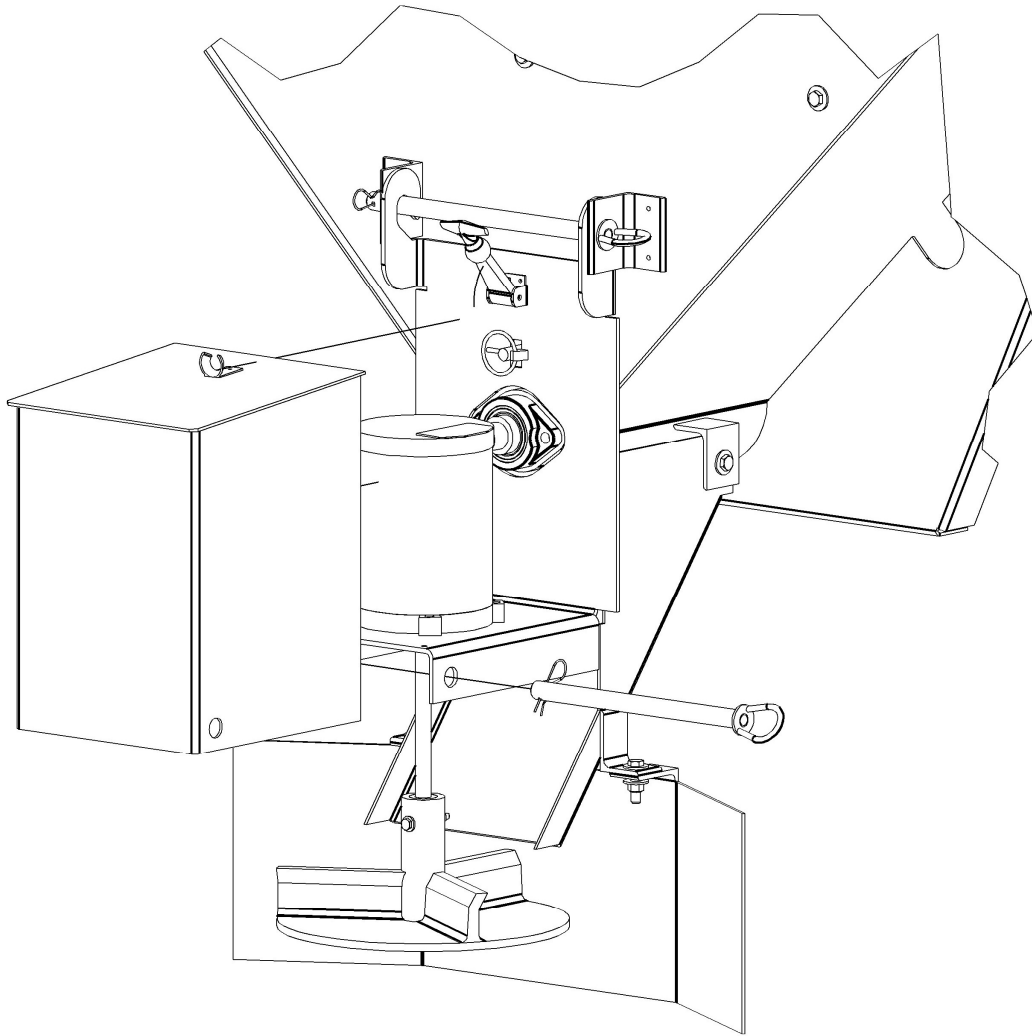

WIRING HARNESS INSTALLATION

(See diagram on page 11.)

1. Install the Electronic Control Unit (ECU) bracket to the underside of the console or the cab floor.
2. Install the ECU onto the bracket with the fasteners provided.
3. Drill a 1.25" hole in the firewall.
4. Install the grommet in the hole. Remove connector from cab harness and feed harness through grommet hole.
5. Feed the cab harness from the ECU to the battery. But do not connect the harness to the battery terminals yet.
6. Drill a 1" hole in firewall.
7. Install the grommet and feed chassis spinner-vibrator harness through hole.
8. Drill another 1" hole in firewall, install the grommet, and feed chassis material feed harness through hole.

9. Feed both chassis harness sections under the truck cab and up between the cab and box. Then run the auger portion of the harness down into the box and to the auger housing. Feed the spinner and vibrator portion through the holes provided on the driver's side of the spreader ribs to the vibrator (halfway) and to the spinner at the rear of the truck.

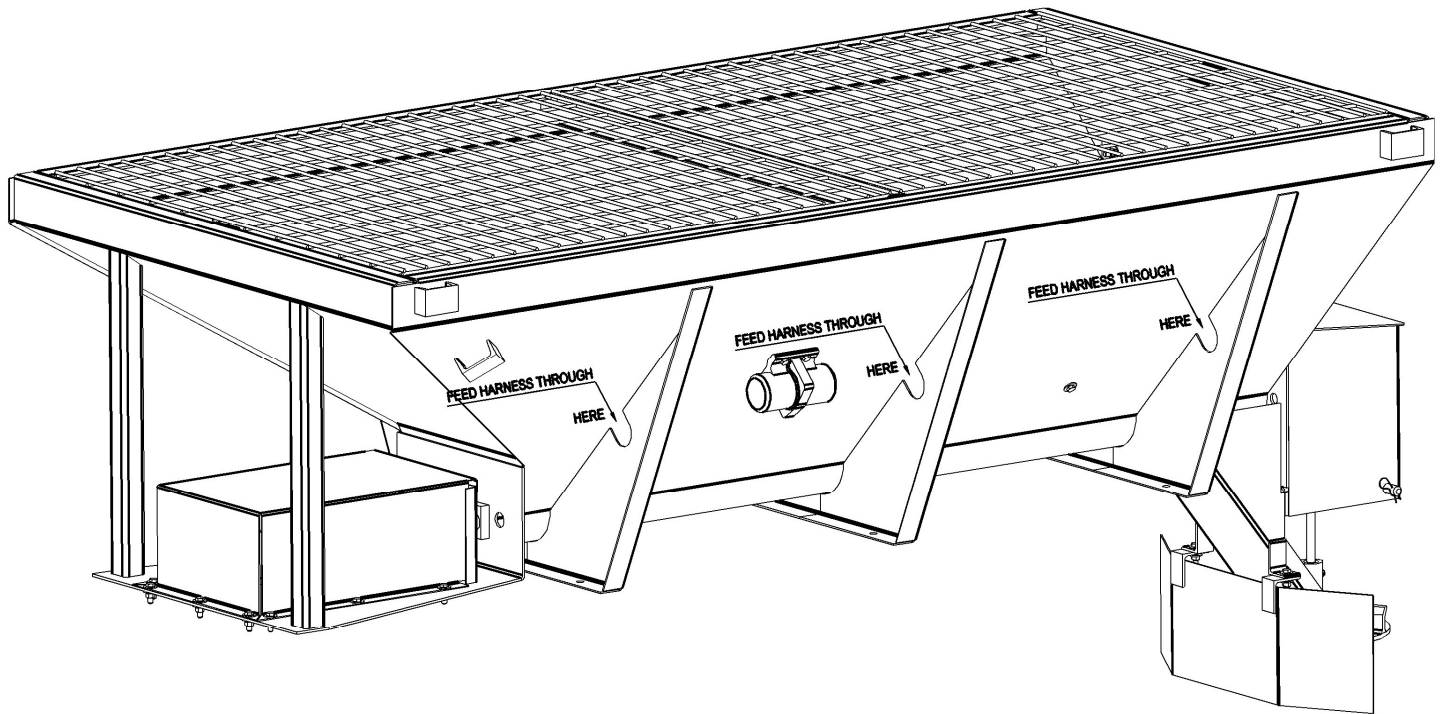

10. Secure the wiring to the truck body and spreader body using the stainless steel mounting bracket(s) provided. Find an appropriate place to install the bracket with the screws, wave washer, and nut supplied. Attach the chassis connector to the bracket. Position the harness and connectors so that they are shielded as much as possible from brine and water.
11. Connect the spinner harness connectors to the spinner motor.
12. Connect the vibrator harness connector to the vibrator.

13. Connect the chassis harness material feed (auger motor) to the spreader harness material feed cable.
14. Now return to the ECU. Once you are at the ECU, connect the harness connectors to the indicated locations on the back of the ECU.
15. With the screws provided, mount the vibrator switch mounting bracket in a suitable location near the ECU, but never attached to the ECU. Then connect the narrow leads to the switch.

Warning: DO NOT attach the vibrator switch mounting bracket or the switch itself to the ECU. Attaching the vibrator switch mounting bracket or the switch to the ECU will damage the internal ECU components, rendering it inoperable and voiding the ECU warranty.

16. Connect cab harness leads to the vehicle battery terminals.
17. At the ECU, turn on the spreader, auger, and spinner to verify correct spin direction and motor function.



PVAS WIRING INSTALLATION DIAGRAM

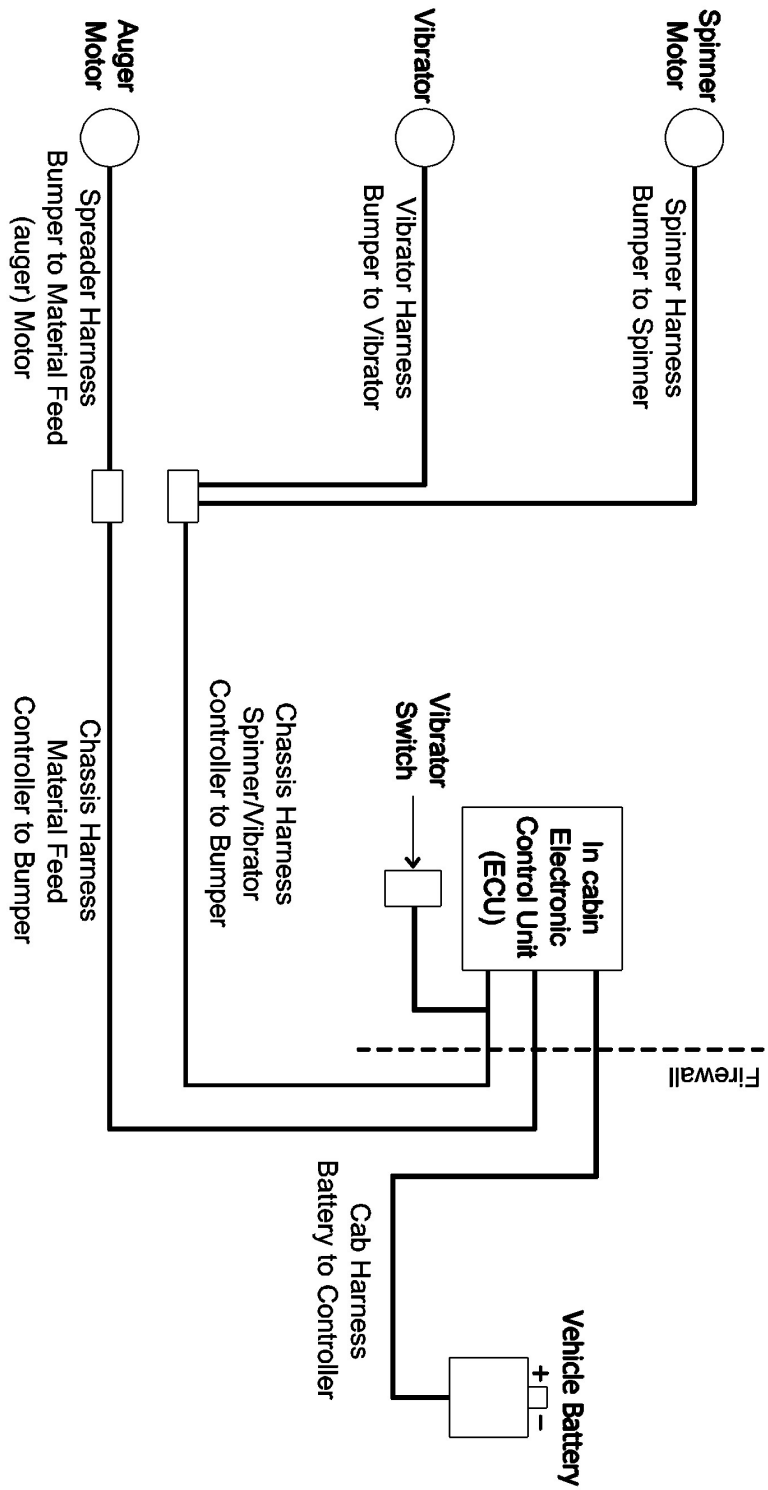

06.DEC.2010



Caution:

When the auger is turned on from the ECU, the spinner will automatically spin for a few seconds. Keep clear of spinner even if only turning on the auger.

Usage and Storage Recommendations:

1. When using the electronic controller, always remove dirty gloves before adjusting settings or powering the system on or off. The electronic controller is a computerized piece of equipment that will be damaged if touched with salt-laden gloves. The controller warranty does not cover circuit damage from corrosive material being introduced from touching the knobs or buttons with dirty gloves.
2. Seal gaps between connectors and wire leads with silicone to protect against corrosion.
3. We advise *against* the use of dielectric grease on the twist lock connectors. If grease is applied inside the connector, the resulting hydraulic pressure will push out the back of the connector, break the individual wire seals and allow water or contaminants to infiltrate the connectors.
4. When the spreader is not in use and/or uninstalled from your vehicle, use the sealing caps provided with your Avalanche® spreader to cover the connectors. The sealing cap for the chassis connector includes a safety chain and clip that are only to be used when the spreader is disconnected from the vehicle. Do not leave the cap attached to the vehicle when the spreader is attached to the vehicle.

MAINTENANCE

1. Wash salt or salt/sand off the spreader unit after every use. Do not power wash around electrical components.
2. Grease bearings every 250 hours of use, or every two months, whichever comes first.
3. Before storing the spreader for extended periods, such as the summer months, it is important to remove both motor housings and wipe the motors clean with a damp cloth. But do not power wash or spray the motors with a garden hose. Always wipe and clean them with a cloth.
4. After storing the spreader for an extended period of time, such as in the summer, an inspection of the motors should be done before starting up the system again. Open the housings, wipe the motors clean with a cloth, and ensure that all ventilation openings are free of obstructions.



AVALANCHE[®] WARRANTY - POLICY D

PVAS G3 (v-box) and DUTS (under-tailgate) Salt Spreaders

The Avalanche[®] snow and ice control products indicated above are guaranteed to be free from defects in material and workmanship for two (2) full years from the date of delivery to the original purchaser. All items manufactured are wearable and expendable. This warranty does not cover consumable parts.

It will be our opinion to replace or repair without charge to the customer, any part(s) according to the following terms:

1. Any spreader or part(s) claimed to be defective are to be returned freight prepaid to the factory for our inspection.
2. Any warranty work done by others must be authorized in writing by an Avalanche[®] official, and billed for the total amount agreed upon before the work is started.
3. Normal wear through usage will not be considered a defect.
4. This warranty covers only parts manufactured by Avalanche[®] /Ledex Industries and is in lieu of all other warranties, expressed or implied. We are not responsible or liable for any consequential damage or contingent liability. This warranty is void if part(s) damaged is the result of negligent or malicious use beyond the rated capacities of the part(s): any modification or unauthorized repair of the part(s).

Important: To activate your warranty, please mail or fax us a copy of your invoice within 30 days of purchase.

November 2010



PRODUCT REGISTRATION

Thank you for taking the time to register. Please fax this form to +1-905-634-5606
or go online at avalanchespreaders.com/activate.

First Name: _____

Last Name/Surname: _____

JobTitle: _____

Company Name: _____

Mailing Address: _____

City: _____ State/Province: _____

Zip/Postal Code: _____ E-mail Address: _____

Tel: _____ Fax: _____

Model(s) Purchased: _____

Serial Number(s): _____

Date Purchased: _____

Purchased From: _____

Tell us why you chose Avalanche®: _____

How would you describe the service you received from our dealer?

How can we improve our products?



CONTACT INFORMATION

Need help?

Toll Free: 1-800-232-6950

E-mail: sales@ledexindustries.com

Fax: +1-905-634-5606

Mail: Avalanche Customer Service
5419 Harvester Road
Burlington, Ontario L7L 5J7
Canada